







**PMMP51  
PMMP51BK**

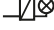

**Compatible load types\***

-  LED
-  Incandescent
-  Fluorescent
-  CFLs
-  Electronic transformers
-  Standard iron core & toroidal transformers
-  Exhaust fans / small motors

**\*Always use a Neutral wire where possible.**  
When operating without a neutral connected, a small amount of power is used via LOAD 1 when switched off. This may in some instances result with lights not completely turning off. Dimmable loads might be fixed by increasing to at least 2 lights with a load >10W. **Non-Dimmable** loads may require a bypass/load correction device fitted if the load is sufficient.

**For use with contactors, please note:**  
1. Use contactors with built-in suppressors (coil section).  
**OR**  
2. If the contactor does not have built-in suppressor, an external RC suppressor must be used.  
**OR**  
3. If possible, use PMPUSWV1G35 (1 Button Powermesh Switch) which will work with all contactor types.  
Refer to Powermesh Customer Service for further advice.

Powermesh products must be installed by a qualified electrician. Zimi requires a compatible (Android, iOS) mobile device. All features, functionality and other product specifications are subject to change without notice or obligation. Powermesh products are optimised for the use with the Zimi App.

**Powermesh Multi Purpose Switch - 1 Button**

- In classic Puma architecture
- Approved to AS/NZ60669.2.1 & AS/NZS CISPR15.
- Fits standard Australian wall boxes and mounting accessories that use 84mm mounting centres.
- Switch terminals have 4mm bore to suit 1.5mm<sup>2</sup> cable.
- Soft touch control.
- Indicator displays the on/off state.
- Software control using the Zimi app, available on the Google Play and App Store.
- Covers, plates and dollies made from UV stabilised polycarbonate to avoid discolouring.
- Standard colour is White. Available in Black.
- Neutral connection not required (2 wire); connect neutral if available (3 wire).
- Auto sensing between 2 wire and 3 wire modes.
- Rating 240V~ AC 50Hz, 5AX max in 3 wire mode,
- 2 wire mode rating 5A max for channel one, suitable load required.
- Multi way switching with multiple devices using 'Behaviour link' (configured using the Zimi app)
- M40 motor rating max.
- Inbuilt scheduling.
- Power outage recovery.
- Control anywhere in the world via the Internet with the Zimi Cloud Connect (Product Code: PMZCC)
- See notes (at left) for use of contactors with these devices

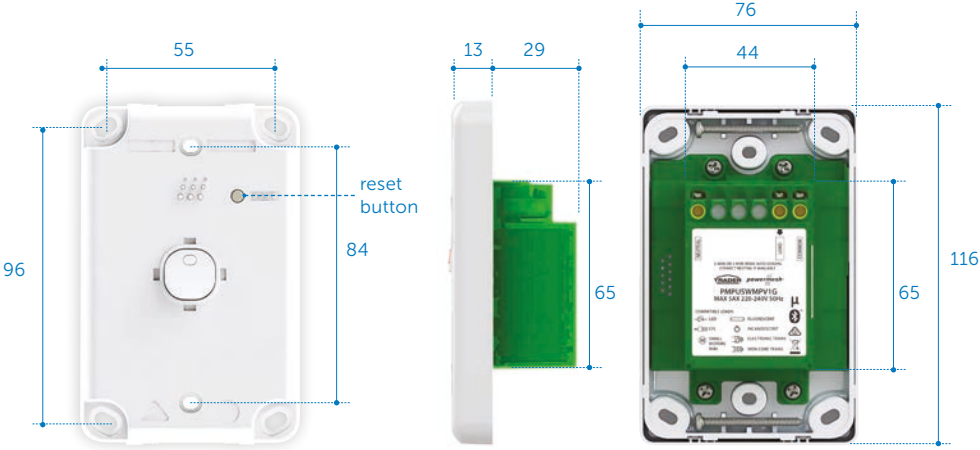

Catalogue Number	Description
PMMP51	Powermesh Multi Purpose Switch Vertical 1 Button, 5AX / 240V~, 2 or 3 wire, White
PMMP51BK	Powermesh Multi Purpose Switch Vertical 1 Button, 5AX / 240V~, 2 or 3 wire, Black
	Powermesh Multi Purpose Switch Horizontal 1 Button, 5AX / 240V~, 2 or 3 wire, White
	Powermesh Multi Purpose Switch Horizontal 1 Button, 5AX / 240V~, 2 or 3 wire, Black